

# S5 150 S 85 / S5 150 S 85 BC



Ergonomic at 360°; an easy to operate machine, steady and total safe in every working condition. The strong squeegee is governed by a parallelogram and is equipped with large bumper wheels. Large opening up to 68° for easy maintenance. The intuitive control panel has a display for onboard diagnostic and check up of all the functions. A socket for cellular phone charging is also present. Easily removable frame and traction unit taken from truck-lift technology (with automatic speed reduction while turning).



Type		
S5 150 S 85		Code 10.0585.00
S5 150 S 85 BC	<b>NEW</b>	Code 13.0585.00

## TECHNICAL DATA

Working width, brush	mm	850
Working width, vacuum	mm	1.050
Area performance	m <sup>2</sup> /h	5.000
Power supply	Batteries	36 V
Installed power	W	2.400
Driver		Traction forward/backward

Brushes		
Diameter/No.	mm/nr	440/17" x 2
Motor rating/No.	W/nr	400 x 2
Motor speed	rpm	190
Contact pressure	gr/cm <sup>2</sup>	30

Traction		
Motor rating	W	900
Driving speed	km/h	6,0
Climbing rate	%	16

Vacuum		
Motor rating	W	650
Vacuum	mbar/mmH <sub>2</sub> O	174/1.800
Airflow rate	l / sec	36
Noise level	dB(A)	67

Tank		
Type		2 separate tanks
Tank fresh/dirt water	l	150/160
Dimensions	mm	1680 x 900 x 1280
Weight without/with batteries	kg	255/543

## STANDARD ACCESSORIES

Brush in polypropylene strong Ø 0,9 (2)	40.0107.00
Brush splash guard	39.0023.00
Side splash guard	39.0029.00
(*) Set 6 gel batteries 6V 270 Ah	18.0011.00
(*) Cabinet charger 36V 28 A	18.0008.00

## SPECIAL ACCESSORIES

Brush PP Ø 0,7 (2)	40.0007.00
Brush PP strong Ø 1,2 (2)	40.0307.00
Tynex brush Ø 1,2 grit 80 (2)	40.0207.00
Drive board Ø 420mm (2)	40.1007.00
Front squeegee	39.0005.00
Front squeegee oil resistant	39.0034.00
Rear squeegee	39.0006.00
Rear squeegee oil resistant	39.0049.00
(*) Set 6 gel batteries 6V 270 Ah	18.0011.00
Gel battery 6V 270 Ah	18.0006.00
Cabinet charger 36V 28 A	18.0008.00

(\*) = For BC version only

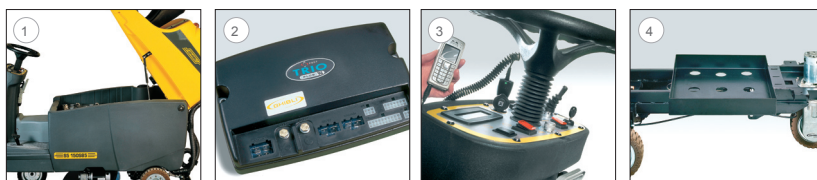

1. Friendly servicing
2. On board computer
3. Control panel with display for onboard diagnostic
4. Sturdy frame
5. Ride on