

WINNER® 38 E

With a cleaning width of 385 mm and two big tanks 16/22 litres, Winner 38E is the right machine for long operating periods without any brakes. Champion of convenience and efficiency, the new range of scrubber driers Ghibli are ergonomic, lightweight and easy to carry thanks its big wheels (200 mm.). Good positioned intuitive controls, adjustable handle, large dimensioned cap for inspection and cleaning of the recovery tank with built-in floating, easily accessible vacuum turbine. Floating brush head is centrally positioned for an easy use next to the walls and obstacles, replaceable with a click, just like the suction bar, in thermoplastic, material free from rust. It is electric powered (220 V) and standard equipped with 15 m. cable.



Type

WINNER 38 E **NEW** Code 10.1238.00

TECHNICAL DATA

Working width, brush	mm	385
Working width, vacuum	mm	470
Performance	m ² /h	1.100
Power supply	-	220 V-50 Hz
Cable	m	15
Installed power	W	680
Drive		Manual

Brushes

Diameter/No.	mm/nr	385/15"x 1
Motor rating/No.	W/nr	370 x 1
Motor speed	rpm	150
Contact pressure	gr/cm ²	35

Traction

Motor rating	W	--
Driving speed	km/h	--
Climbing rate	%	2

Vacuum

Motor rating	W	300
Vacuum	mbar/mmH ₂ O	68/700
Airflow rate	l/s	28
Noise level	dB(A)	65

Tank

Type		2 separate tanks
Tank fresh/dirt water	l	16/22
Dimensions	mm	760 x 400 x 550
Weight	kg	40

STANDARD ACCESSORIES

Brush in polypropylene Ø 0,9 40.0108.00

SPECIAL ACCESSORIES

Brush in polypropylene Ø 0,7	40.0008.00
Tynex brush Ø 0,9 grit 240	40.0208.00
Drive board Ø 352 mm	40.1008.00
Front squeegee	39.0077.00
Front squeegee, oil resistant	39.0070.00
Rear squeegee	39.0078.00
Rear squeegee, oil resistant	39.0071.00

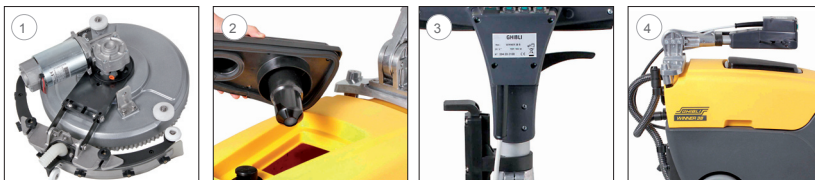

1. Rotating squeegee
2. Inspection cap + floating
3. Squeegee lifting control
4. Adjustable handle